

Transportation in 4 units

- ① Frame 1 with SCU and power panel LxWxH = approx..3500x1800x2050, mass = approx. 4000 kg
- ② Frame 2 with plate heat exchanger LxWxH = approx.. 4000x1200x1900, mass = approx. 3000 kg
- ③ Liquid separator DmxH = approx.. 610x1700, mass = approx. 400 kg
- ④ suction line

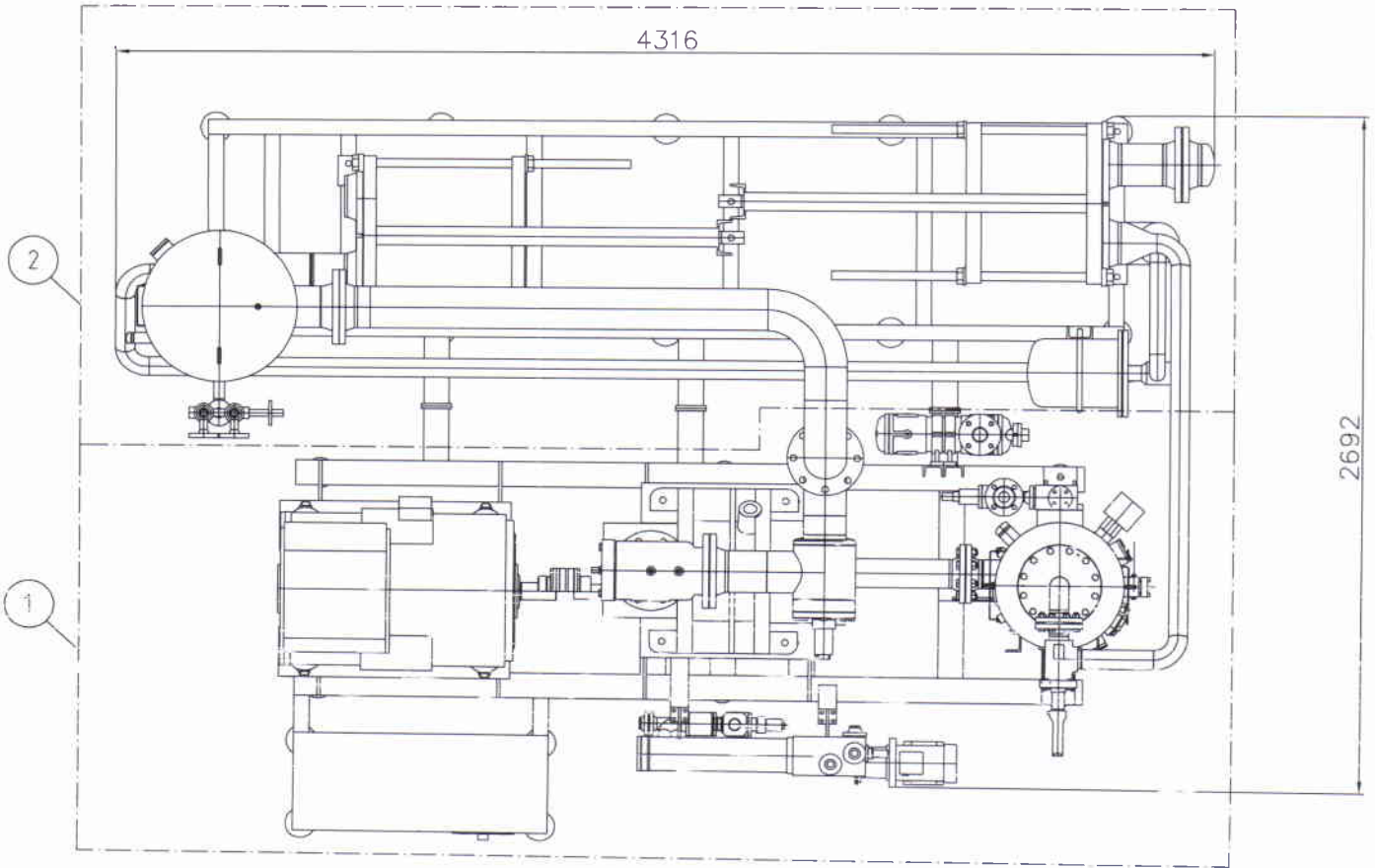

Für Einbringung Demontage der

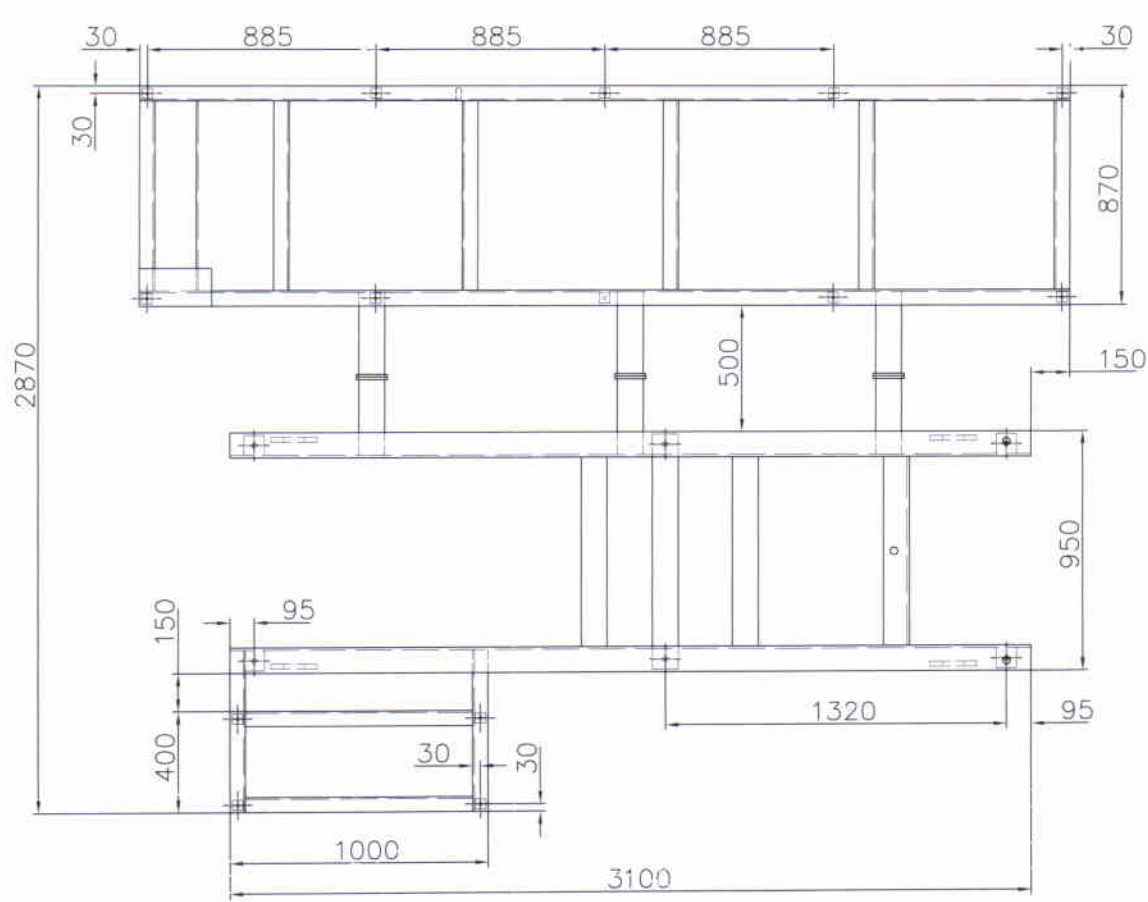
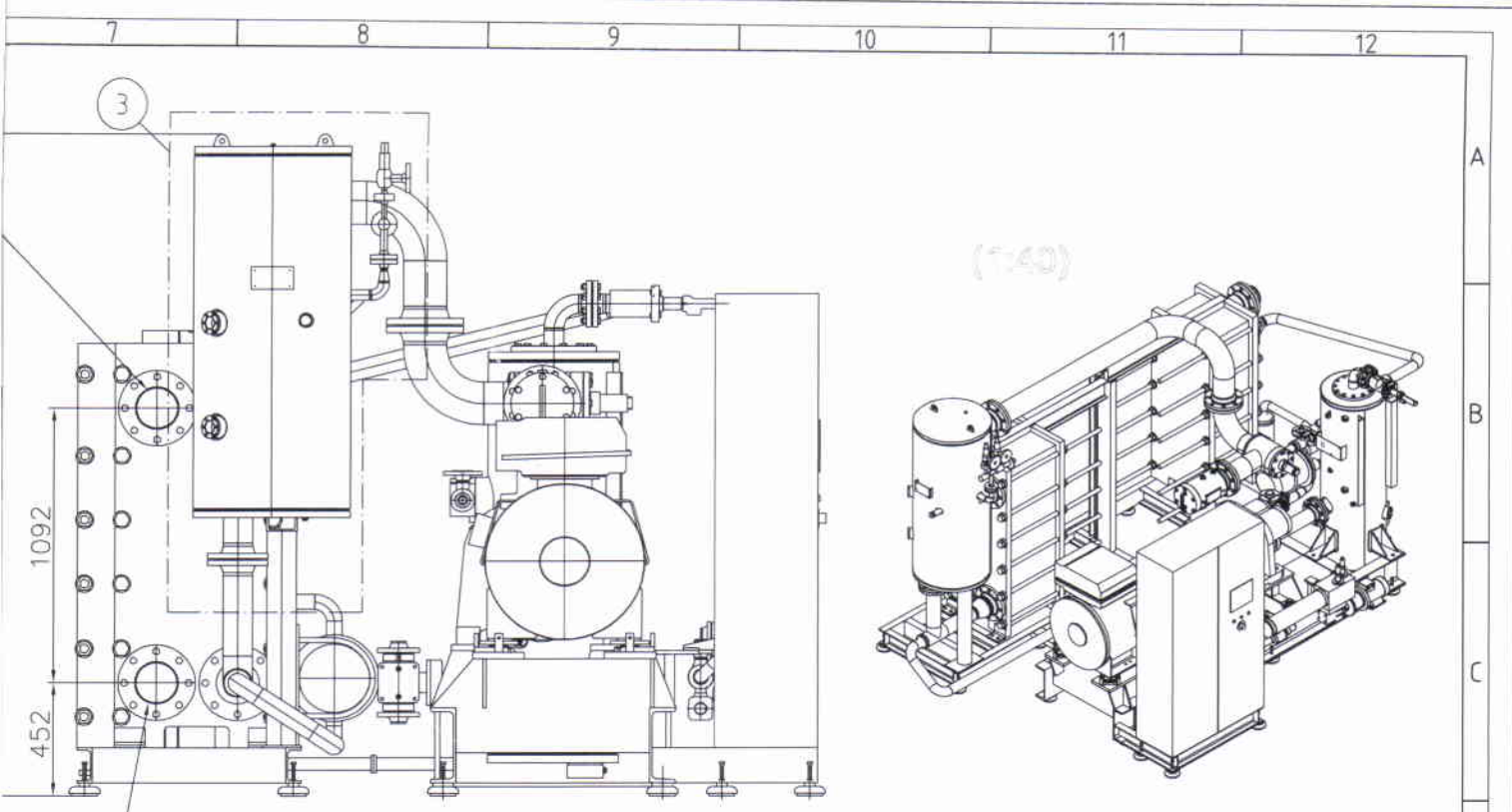

ISU-system E		DIN ISO 2769		AutoCAD®		scale: 1:20	mass: - kg
		mittel:				SHUTEMA 2	
		AF	date	name		general drawing/Überzichtsschema FX PP 1300 NH3	
		works o.	20.06.2005	Wehrstedt			
		const.	20.06.2005	Bussenius			
		calcul.					
		exam.					
03	Demontage DS	10.08.2005	Bus			64 7043 : 13111 - 2	
02	Position Schaltachrank	27.07.2005	Weh				
01	Behälter + Rahmen geflanscht	07.07.2005	Franz			page 1	
Zust. Änderungen		Datum	Name	EDV No. 64 7043ndl-gbr2_03		1 p.	

Druckseite vornehmen!